

YOUR PARTNER FOR METERING  
AND MIXING TECHNOLOGY

**BUILDING & CONSTRUCTION**



## WHO WE ARE – AND WHAT WE STAND FOR

Joined materials – metals, glass, plastics and composites can be found everywhere in our world, countless products are made out of them. Bonding technologies have more and more replaced traditional joining processes during recent years, and Reinhardt-Technik has adopted to this trend early.

What started in 1962 with a team of ambitious engineers has grown over half a century to a leading global supplier of dosing and mixing plants with a proven record of innovative solutions in the market place.

Processing liquid performance materials for bonding, sealing, moulding and surface treatment applications combined with system integration and process control are our well recognized core competences.

As a technology leader in the field of adhesive and sealant processing solutions we belong to the J. Wagner GmbH since 2012.

Wagner is a leading manufacturer of surface technology, with more than 1,400 employees globally and headquarters in Markdorf near Lake Constance.

- › **Customer orientation**
- › **Partnership**
- › **Innovative products**
- › **Individual solutions**
- › **Automation**
- › **Reliable applications**
- › **Global service**



# BUILDING & CONSTRUCTION

The requirements for buildings, whether domestic houses or commercial buildings, are becoming more demanding. Essentially, this is shaped by governmental energy regulations, fire safety measures, local construction standards and not least by the functional and design requirements of their owners.

In order to meet all these requirements architects and designers need to specify the correct materials and components carefully. More than 2/3 of the value of a building accounts for building and construction elements and their installation.

Looking at the total investment in building and construction elements, it is obvious that nowadays the competitiveness of the manufacturers are directly linked to the utilization of modern and efficient production methods.

Bonding technology is already industry standard for many assembly processes.

In-place-bonding and sealing can replace traditional joining technologies in many cases and help to streamline production processes accompanied by significant cost savings.

Reinhardt-Technik is a preferred supplier of metering and mixing technology to many industries.

We offer a broad range of products to process liquid single or multi-component materials for various applications, like bonding, sealing, casting and others. Starting from simple manual applications to complete solutions with fully automated robot cells with integrated process control – plus service and parts availability

Reinhardt-Technik is a partner to many major material manufacturers helping to optimize processes and find new solutions for the market – for the benefit of our customers.

Learn more about manufacturing applications and our products & solutions...



# TYPICAL APPLICATIONS

1

## Sandwich Panels / Isolation

- Bonding of sandwich panels
- Bonding/ Lamination of technical fabrics
- Bonding of brackets and threads into panel
- Bonding of honeycomb structures



11

## Elevators

- Bonding of elevator cabins
- Bonding of interior panels & components



7

## Gasmeter

- Bonding and sealing of diaphragm elements
- FIP-Gasketing of gasmeter housing

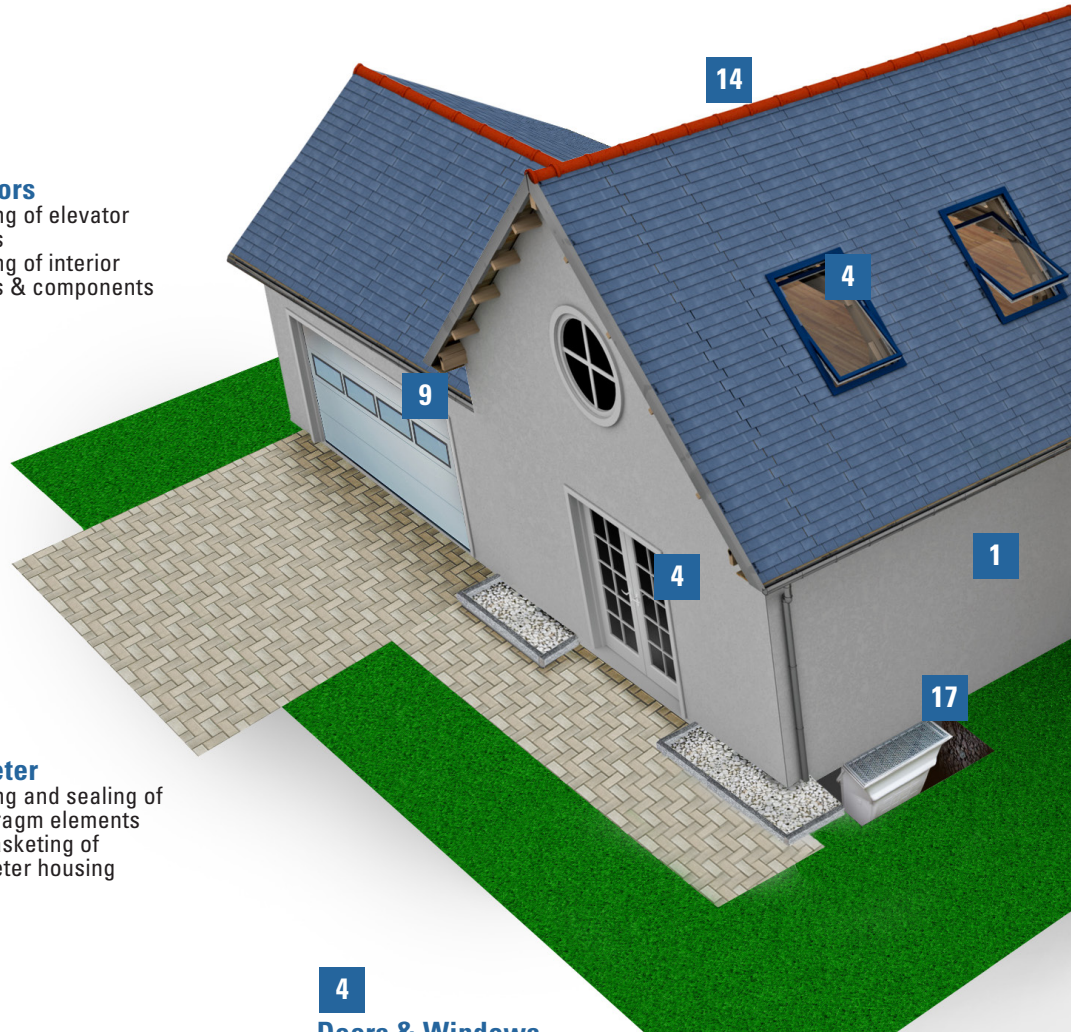

14

4

9

1

4

17

4

## Doors & Windows

- Direct Glazing, Secondary sealing, structural glazing
- Bonding of frame structure
- Bonding of honeycomb structures
- Assembly bonding of front doors

## Conti Flow Robot

Configurable & flexible precision gear metering system for integration in automated plants.

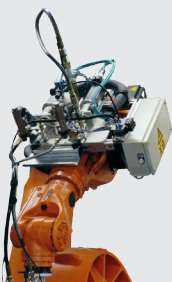

## Conti Flow Vario

Variable precision gear metering system



## Conti Flow Versa

Flexible and versatile gear metering system for manual applications





2

### Air Conditioning and Heating

- Assembly bonding of components
- FIP-Gasketing of housing & duct parts
- Lamination of isolation blankets

3

### Roller Shutter Casing

- Bonding of isolation blocks
- Sealing and FIP-Gasketing of housing

5

### Shower Cabins

- Bonding and sealing of glass to frame
- Bonding of glassfiber net to shower floor sinks

6

### Basin Taps

- Encapsulation /casting of sensors

8

### Electrical Cabinet

- FIP-Gasketing of electrical cabinet

9

### Garage doors

- Sealing of windows
- Bonding of element structures

10

### Mirrors

- Bonding brackets or frames to mirrors

12

### Electronics & Lighting

- Bonding, sealing, encapsulation (casting) of electronic and lighting products

13

### Roof Truss

- Bonding of (pre-fabricated) roof truss structures

14

### Roofing, Ridge Vents

- Bonding and sealing of ridge vents

15

### Wall elements

- Assembly bonding of (pre-fabricated) walls

16

### Ventilated Facades

- Bonding of brackets to facade elements
- Bonding of glassfiber net to tile-back

18

### Concrete casings

- Bonding and Sealing of concrete casings.

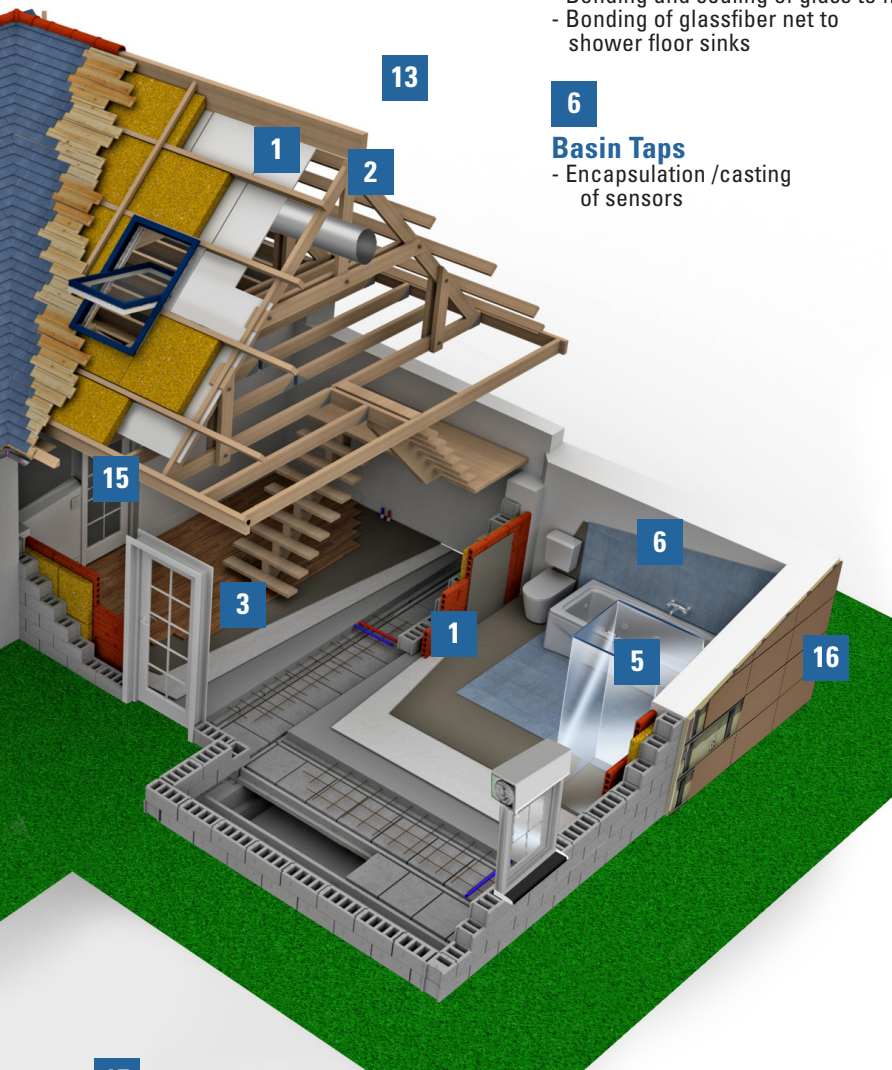

17

### Lightwells

- Preparation of SMC prepregs

## Ecostar evo

Powerful piston meter mix system for manual applications



## Vecdos™ eTwin

Precision shot meter system



## eZbotic™

Standardized and compact robot cell. Configurable with any metering system.



## ContiPro™

Progressive cavity metering system for abrasive or sensitive materials



# APPLICATION / SOLUTION MATRIX

PRODUCTS	APPLICATION	MATERIALS	SOLUTION
Sandwich Panels / Isolation	Bonding of sandwich panels Bonding/ Lamination of technical fabrics Bonding of brackets and threads into panel Bonding of honeycomb structures	2K Polyurethane 2K Silicon	<ul style="list-style-type: none"> <li>■ Ecostar evo</li> <li>■ Conti Flow Robot</li> <li>■ Conti Flow Versa</li> <li>■ Vecdos eTwin</li> </ul>
Air Conditioning and Heating	Assembly bonding of components FIP-Gasketing of housing & duct parts Lamination of isolation blankets	2K Polyurethane 2K Silicon	<ul style="list-style-type: none"> <li>■ Conti Flow Versa</li> <li>■ Conti Flow Robot</li> <li>■ Vecdos eTwin</li> <li>■ eZbotic</li> </ul>
Roller Shutter Casing	Bonding of isolation blocks Sealing and FIP-Gasketing of housing	2K Polyurethane 2K Silicon	<ul style="list-style-type: none"> <li>■ Ecostar evo</li> <li>■ Conti Flow Robot</li> <li>■ Conti Flow Versa</li> <li>■ Vecdos eTwin</li> </ul>
Doors & Windows	Direct Glazing, Secondary sealing, structural glazing Bonding of frame structure Bonding of honeycomb structures assembly bonding of front doors	2K Polyurethane 2K Silicon	<ul style="list-style-type: none"> <li>■ Conti Flow Robot</li> <li>■ Conti Flow Vario</li> <li>■ Conti Flow Versa</li> <li>■ Vecdos eTwin</li> </ul>
Shower Cabins	Bonding and sealing of glass to frame Bonding of glassfiber net to shower floor sinks	2K Silicon	<ul style="list-style-type: none"> <li>■ Conti Flow Robot</li> <li>■ Conti Flow Versa</li> <li>■ Vecdos eTwin</li> </ul>
Basin Taps	Encapsulation / casting of sensors	2K Silicon	<ul style="list-style-type: none"> <li>■ Conti Flow Vario</li> <li>■ Conti Flow Robot</li> <li>■ ContiPro</li> <li>■ eZbotic</li> </ul>
Gasmeter	Bonding and sealing of diaphragm elements FIP-Gasketing of gasmeter housing	2K Silicon	<ul style="list-style-type: none"> <li>■ Conti Flow Robot</li> <li>■ Vecdos eTwin</li> <li>■ Conti Pro</li> <li>■ eZbotic</li> </ul>
Electrical Cabinet	FIP-Gasketing of electrical cabinet	2K Polyurethane	<ul style="list-style-type: none"> <li>■ Conti Flow Robot</li> </ul>
Garage doors	Sealing of windows Bonding of element structures	2K Epoxies 2K Polyurethane	<ul style="list-style-type: none"> <li>■ Conti Flow Robot</li> <li>■ Conti Flow Versa</li> <li>■ Vecdos eTwin</li> <li>■ Ecostar evo</li> </ul>

## PRODUCTS

## APPLICATION

## MATERIALS

## SOLUTION

Mirrors

Bonding brackets or frames to mirrors

2K Silicon

- Conti Flow Versa
- Conti Flow Robot

Elevators  
(Residential &  
Commercial)

Bonding of elevator cabins  
Bonding of interior panels & components

2K Polyurethane  
2K Silicon

- Conti Flow Versa
- Ecostar evo
- Conti Flow Robot

Electronics &  
Lighting

Bonding, sealing, encapsulation (casting)  
of electronic and lighting products

2K Silicon  
2K Polyurethane  
2K Epoxies

- eZbotic
- Conti Pro
- Conti Flow Vario
- Conti Flow Robot
- Vecdos eTwin

Roof Truss

Bonding of (pre-fabricated) roof  
truss structures

2K Polyurethane

- Conti Flow Versa
- Ecostar evo

Roofing,  
Ridge Vents

Bonding and sealing of ridge vents

2K Polyurethane

- Conti Flow Versa
- Conti Flow Robot

Wall elements

Assembly bonding of  
(pre-fabricated) walls

2K Polyurethane  
2K Silicon

- Conti Flow Versa
- Ecostar evo

Ventilated  
Facades

Bonding of brackets to facade elements  
Bonding of glassfiber net to tile-back

2K Polyurethane

- Conti Flow Versa
- Conti Flow Robot
- Vecdos eTwin

Lightwells

Preparation of SMC prepregs

1K Polyesterresin  
2K Polyesterresin

- Conti Flow Vario

Concrete casings

Bonding and Sealing of concrete  
casings.

2K Polyurethane  
2K Silicon

- Conti Flow Versa
- Conti Flow Robot

Gas stations  
Air ports  
Ports  
Petro Chemical plants

Sealing of floor seams

2K Polysulfid

- Ecostar evo



## YOUR GLOBAL PARTNER IN METERING AND MIXING TECHNOLOGY

- **Processing and application of single and multi component adhesive and sealants**
- **Ambient and temperature conditioned equipment**
- **Complete systems for manual or fully automatic processes**
- **Innovative process control and verification**

